

Part #	Qty	Description
1	1	Backbone
2	8	Gusset
3	1	Angle Mount - Right
4	1	Angle Mount - Left
5	2	End Cap (OPTIONAL)
6	4	1/2" Dia, 2.5" long HHCS

REVISIONS		DATE	APPROVED
ZONE	REV.	DESCRIPTION	

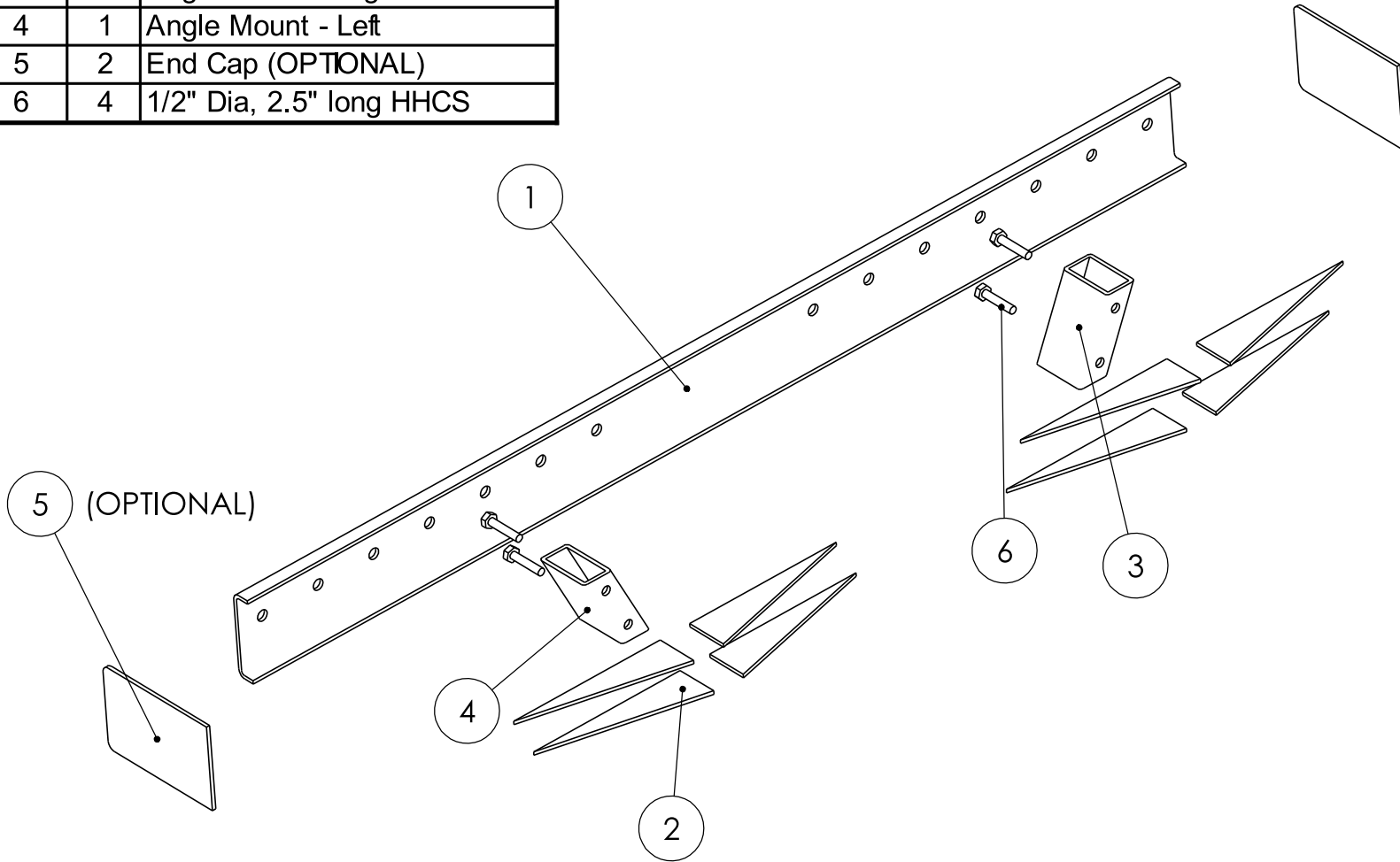

DIMENSIONS ARE IN INCHES		NAME	DATE	HDC, Inc.
TOLERANCES:		DRAWN	CAK	
FRACTIONAL ±		CHECKED		ABumper Mount FORD
ANGULAR: MACH ± BEND ±		ENG APPR.		
TWO PLACE DECIMAL ±		MFG APPR.		
THREE PLACE DECIMAL ±		Q.A.		
MATERIAL	--	COMMENTS:		
FINISH	--			
DO NOT SCALE DRAWING				
SIZE	DWG. NO.	REV.		
SCALE:1:10	WEIGHT:	SHEET 1 OF 10		

.....
 THE INFORMATION CONTAINED IN THIS DRAWING IS THE SOLE PROPERTY OF HDC, Inc. ANY REPRODUCTION IN PART OR AS A WHOLE WITHOUT THE WRITTEN PERMISSION OF HDC, Inc. IS PROHIBITED.

		REVISIONS			
ZONE	REV.	DESCRIPTION	DATE	APPROVED	

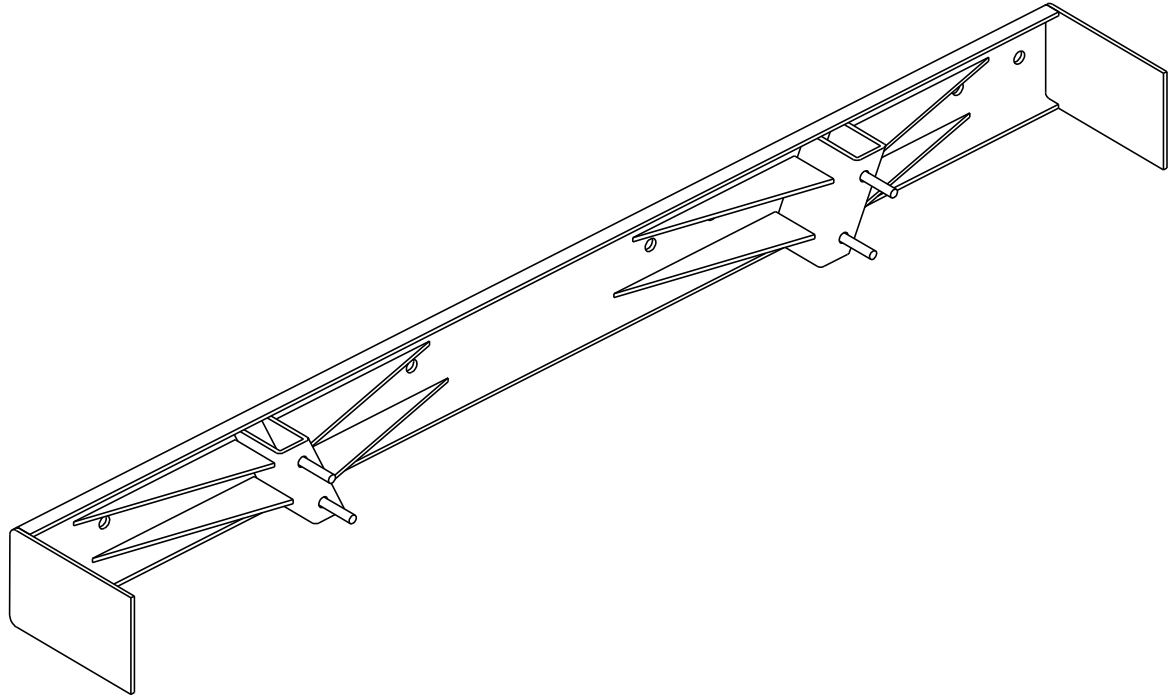

.....
 THE INFORMATION CONTAINED IN THIS DRAWING IS THE SOLE PROPERTY OF HDC, Inc. ANY REPRODUCTION IN PART OR AS A WHOLE WITHOUT THE WRITTEN PERMISSION OF HDC, Inc. IS PROHIBITED.

DIMENSIONS ARE IN INCHES
 TOLERANCES:
 FRACTIONAL ±
 ANGULAR: MACH ± BEND ±
 TWO PLACE DECIMAL ±
 THREE PLACE DECIMAL ±

MATERIAL	--
FINISH	--
DO NOT SCALE DRAWING	

	NAME	DATE
DRAWN	CAK	09/11/2006
CHECKED		
ENG APPR.		
MFG APPR.		
Q.A.		
COMMENTS:		

HDC, Inc.

**ABumper Mount
 FORD**

SIZE	DWG. NO.	REV.
•		

SCALE:1:10 WEIGHT: SHEET 2 OF 10

		REVISIONS			
ZONE	REV.	DESCRIPTION	DATE	APPROVED	

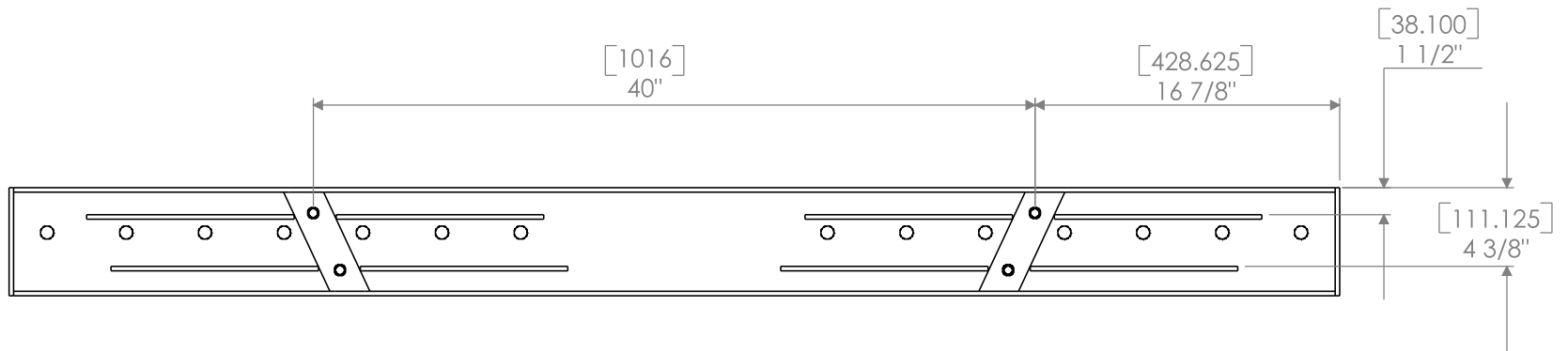

.....
 THE INFORMATION CONTAINED IN THIS DRAWING IS THE SOLE PROPERTY OF HDC, Inc. ANY REPRODUCTION IN PART OR AS A WHOLE WITHOUT THE WRITTEN PERMISSION OF HDC, Inc. IS PROHIBITED.

DIMENSIONS ARE IN INCHES		NAME	DATE	HDC, Inc.	
TOLERANCES:		DRAWN	CAK		
FRACTIONAL ±		CHECKED		ABumper Mount FORD	
ANGULAR: MACH ± BEND ±		ENG APPR.			
TWO PLACE DECIMAL ±		MFG APPR.			
THREE PLACE DECIMAL ±		Q.A.			
MATERIAL	--	COMMENTS:		SIZE	DWG. NO.
FINISH	--			•	
DO NOT SCALE DRAWING				SCALE:1:10	WEIGHT:
				SHEET 3 OF 10	

REV.

REVISIONS				
ZONE	REV.	DESCRIPTION	DATE	APPROVED

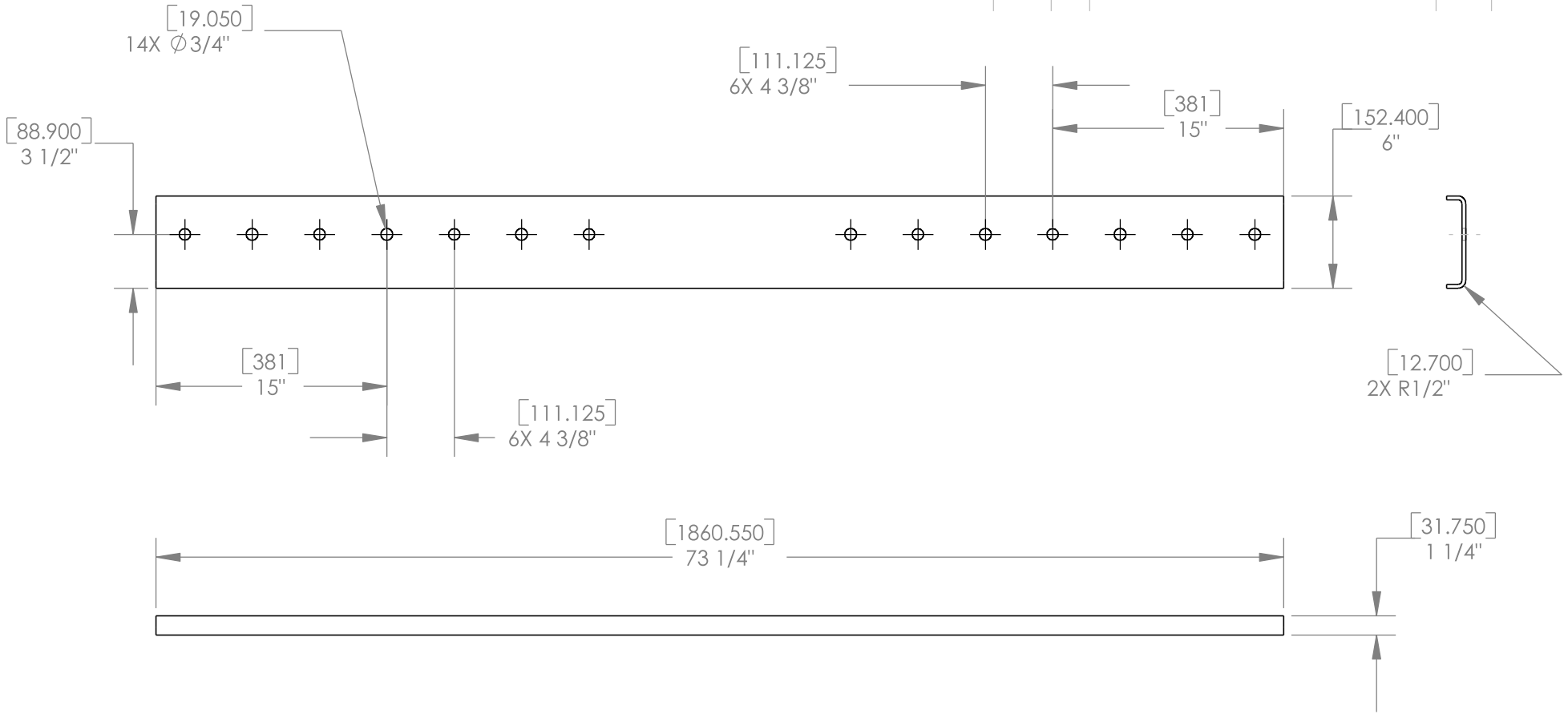

Thickness: 0.25"

.....
 THE INFORMATION CONTAINED IN THIS DRAWING IS THE SOLE PROPERTY OF HDC, Inc. ANY REPRODUCTION IN PART OR AS A WHOLE WITHOUT THE WRITTEN PERMISSION OF HDC, Inc. IS PROHIBITED.

DIMENSIONS ARE IN INCHES		NAME	DATE
TOLERANCES:		DRAWN	CAK
FRACTIONAL ±		CHECKED	09/08/2006
ANGULAR: MACH ± BEND ±		ENG APPR.	
TWO PLACE DECIMAL ±		MFG APPR.	
THREE PLACE DECIMAL ±		Q.A.	
MATERIAL		COMMENTS:	
1/4" Structural Channel			
FINISH			
--			
DO NOT SCALE DRAWING			

HDC, Inc.		
Backbone		
SIZE	DWG. NO.	REV.
•		
SCALE: 1:10	WEIGHT:	SHEET 4 OF 10

REVISIONS				
ZONE	REV.	DESCRIPTION	DATE	APPROVED

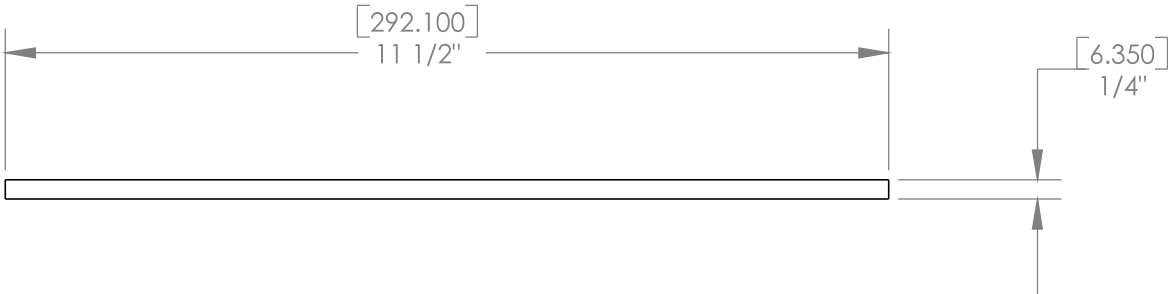
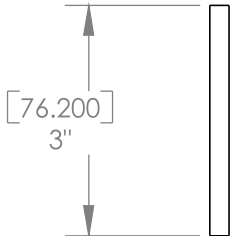
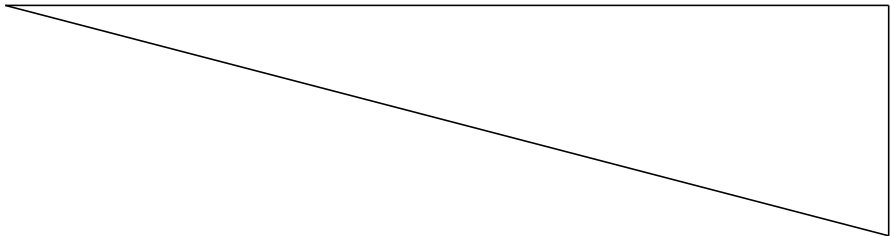

.....
 THE INFORMATION CONTAINED IN THIS DRAWING IS THE SOLE PROPERTY OF HDC, Inc. ANY REPRODUCTION IN PART OR AS A WHOLE WITHOUT THE WRITTEN PERMISSION OF HDC, Inc. IS PROHIBITED.

DIMENSIONS ARE IN INCHES
 TOLERANCES:
 FRACTIONAL ±
 ANGULAR: MACH ± BEND ±
 TWO PLACE DECIMAL ±
 THREE PLACE DECIMAL ±

MATERIAL
1/4" Flat Stock
 FINISH --
 DO NOT SCALE DRAWING

	NAME	DATE
DRAWN	CAK	09/11/2006
CHECKED		
ENG APPR.		
MFG APPR.		
Q.A.		
COMMENTS:		

HDC, Inc.

Gusset

SIZE	DWG. NO.	REV.
•		

SCALE: 1:2.5 WEIGHT: SHEET 5 OF 10

ZONE		REV.	REVISIONS	DESCRIPTION	DATE	APPROVED

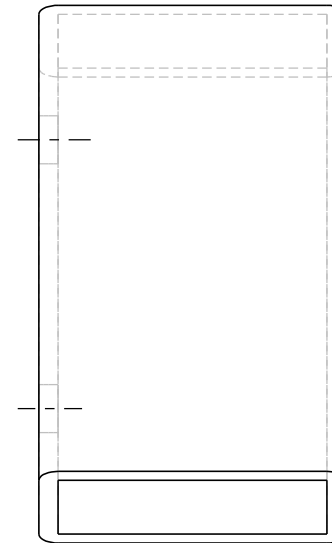
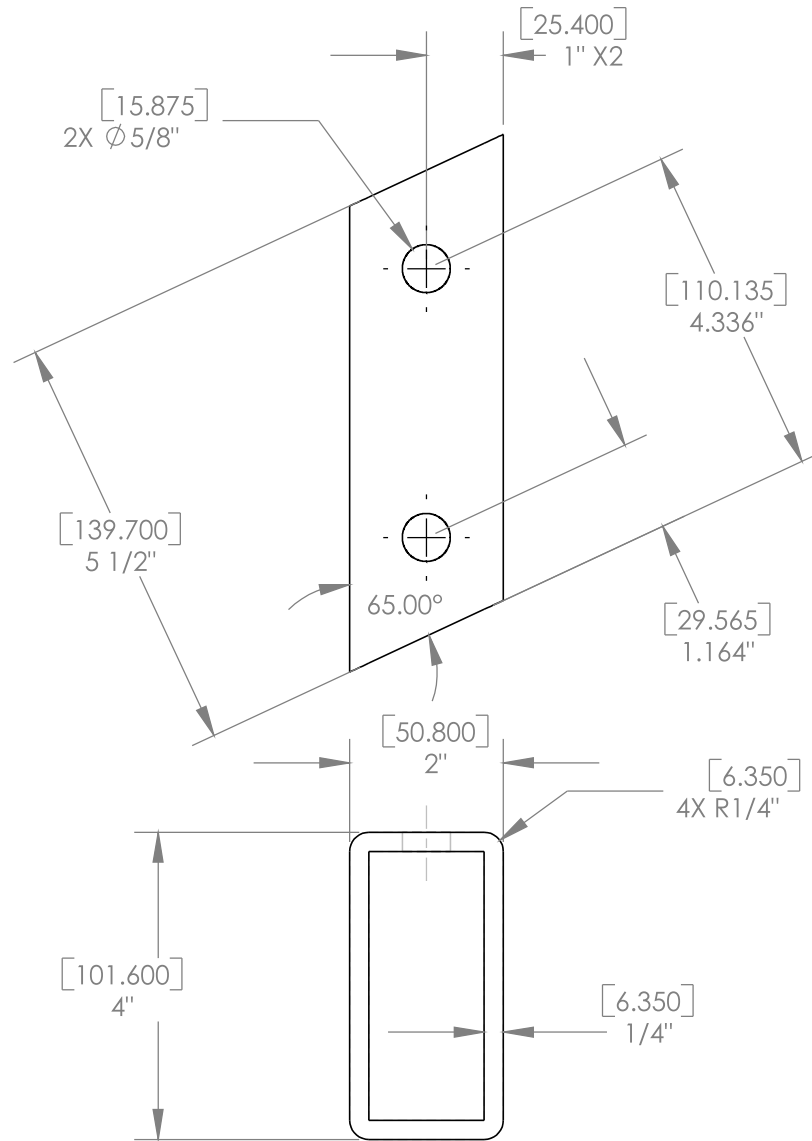

DIMENSIONS ARE IN INCHES
 TOLERANCES:
 FRACTIONAL ±
 ANGULAR: MACH ± BEND ±
 TWO PLACE DECIMAL ±
 THREE PLACE DECIMAL ±

	NAME	DATE
DRAWN	CAK	09/11/2006
CHECKED		
ENG APPR.		
MFG APPR.		
Q.A.		

HDC, Inc.

Angle Mount - Right

.....
 THE INFORMATION CONTAINED IN THIS DRAWING IS THE SOLE PROPERTY OF HDC, Inc. ANY REPRODUCTION IN PART OR AS A WHOLE WITHOUT THE WRITTEN PERMISSION OF HDC, Inc. IS PROHIBITED.

MATERIAL
 1/4" Rect. Steel Tubing

FINISH --

DO NOT SCALE DRAWING

COMMENTS:

SIZE	DWG. NO.	REV.
•		

SCALE: 1:2.5 WEIGHT: SHEET 6 OF 10

REVISIONS			
ZONE	REV.	DESCRIPTION	DATE

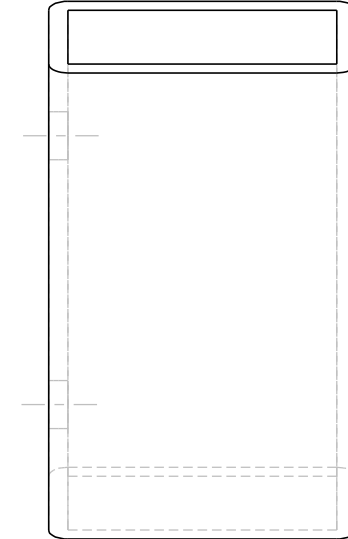
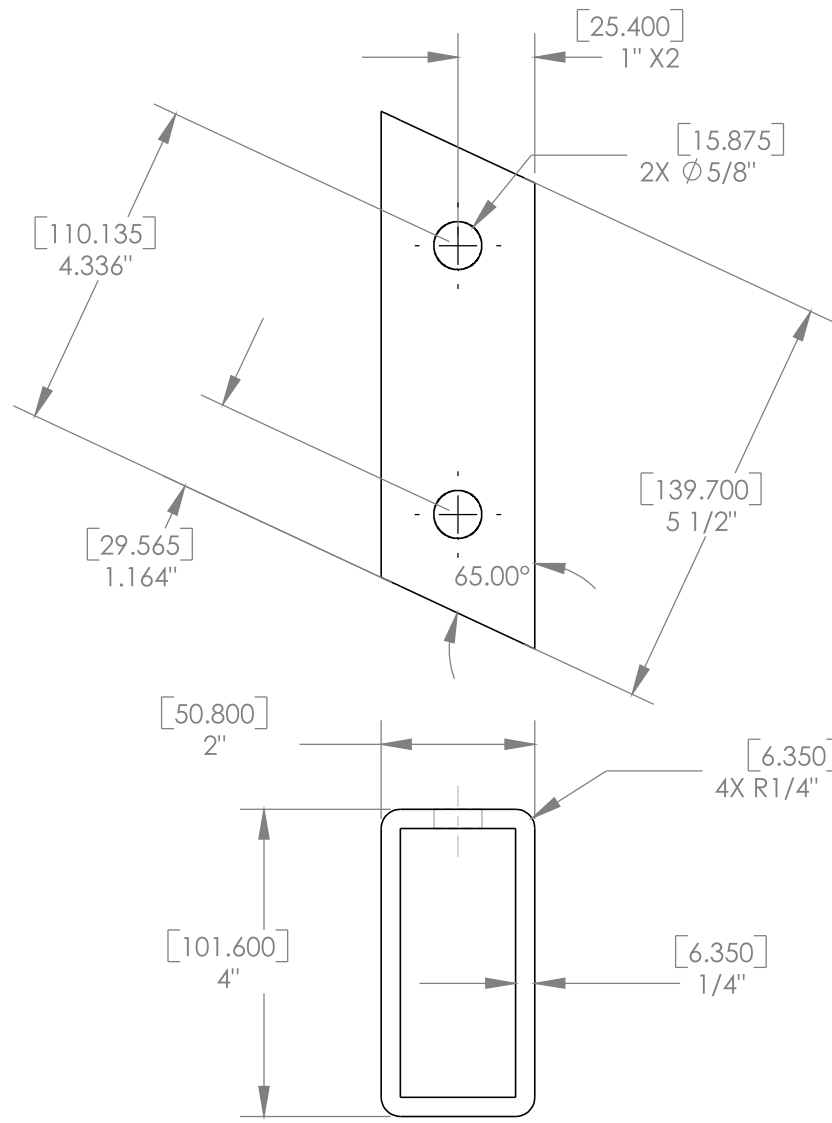

.....
 THE INFORMATION CONTAINED IN THIS DRAWING IS THE SOLE PROPERTY OF HDC, Inc. ANY REPRODUCTION IN PART OR AS A WHOLE WITHOUT THE WRITTEN PERMISSION OF HDC, Inc. IS PROHIBITED.

DIMENSIONS ARE IN INCHES
 TOLERANCES:
 FRACTIONAL ±
 ANGULAR: MACH ± BEND ±
 TWO PLACE DECIMAL ±
 THREE PLACE DECIMAL ±

MATERIAL
 1/4" Rect. Steel Tubing

FINISH
 --

DO NOT SCALE DRAWING

	NAME	DATE
DRAWN	CAK	09/11/2006
CHECKED		
ENG APPR.		
MFG APPR.		
Q.A.		

COMMENTS:

HDC, Inc.

Angle Mount - Left

SIZE	DWG. NO.	REV.
•		

SCALE: 1:2.5 WEIGHT: SHEET 7 OF 10

REVISIONS				
ZONE	REV.	DESCRIPTION	DATE	APPROVED

[12.700]
2X R1/2"

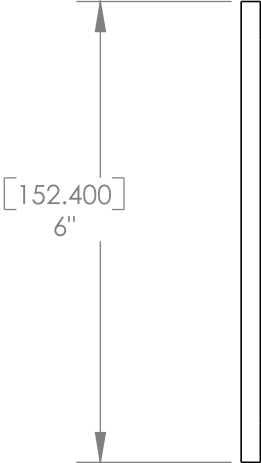
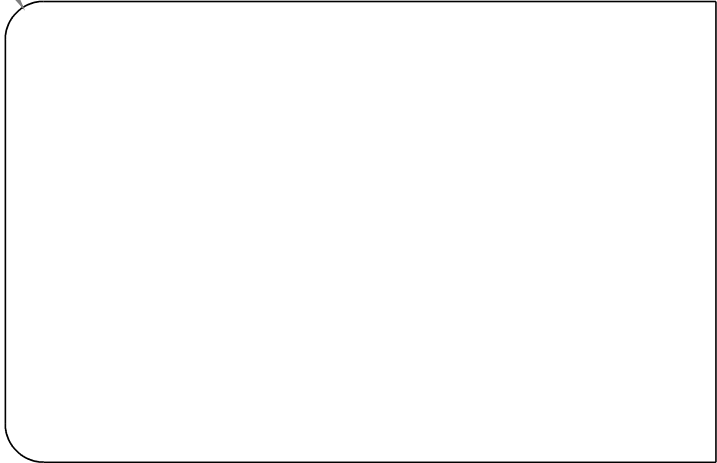

[152.400]
6"

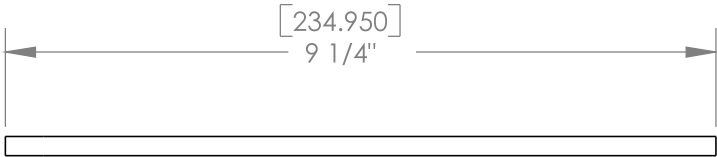

[234.950]
9 1/4"

[6.350]
1/4"

DIMENSIONS ARE IN INCHES
TOLERANCES:
FRACTIONAL ±
ANGULAR: MACH ± BEND ±
TWO PLACE DECIMAL ±
THREE PLACE DECIMAL ±

MATERIAL
1/4" Flat Stock
FINISH --
DO NOT SCALE DRAWING

.....
THE INFORMATION CONTAINED IN THIS DRAWING IS THE SOLE PROPERTY OF HDC, Inc. ANY REPRODUCTION IN PART OR AS A WHOLE WITHOUT THE WRITTEN PERMISSION OF HDC, Inc. IS PROHIBITED.

	NAME	DATE
DRAWN	CAK	09/11/2006
CHECKED		
ENG APPR.		
MFG APPR.		
Q.A.		
COMMENTS:		

HDC, Inc.

End Cap

SIZE	DWG. NO.	REV.
•		
SCALE: 1:2.5	WEIGHT:	SHEET 8 OF 10

Part #	Qty	Description
7	14	1/2"-13 HHCS, 2.75" long, 1.55" thrd
8	14	1/2" Nylon Locking Nut
9	28	0.625" ID, 1.00" OD Washer
10	2	ABumper Pad
11	14	Metal Backing

REVISIONS				
ZONE	REV.	DESCRIPTION	DATE	APPROVED

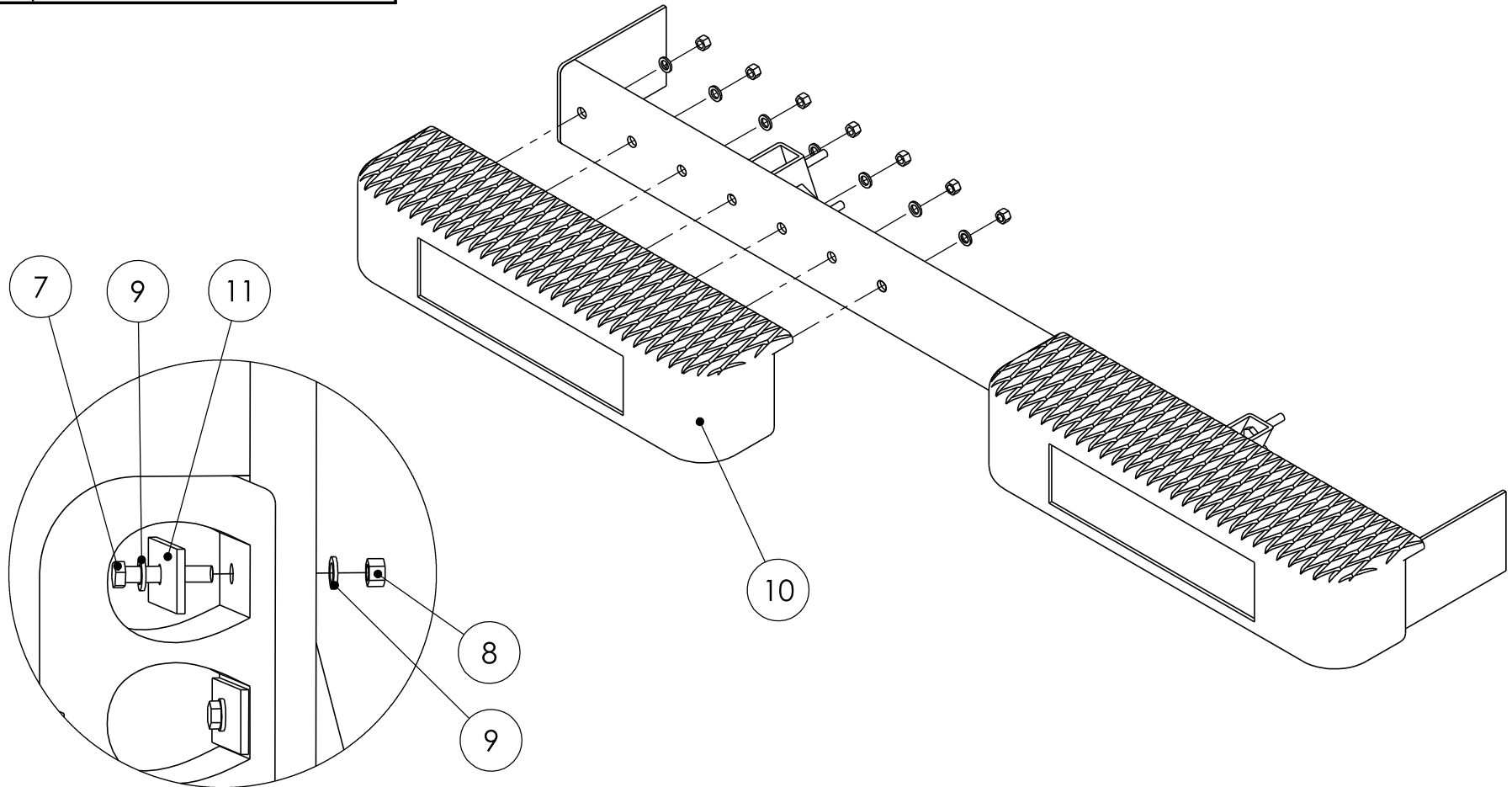

Hardware Mounting

.....
 THE INFORMATION CONTAINED IN THIS DRAWING IS THE SOLE PROPERTY OF HDC, Inc. ANY REPRODUCTION IN PART OR AS A WHOLE WITHOUT THE WRITTEN PERMISSION OF HDC, Inc. IS PROHIBITED.

		DIMENSIONS ARE IN INCHES		NAME	DATE
		TOLERANCES:		DRAWN	???
		FRACTIONAL ±		CHECKED	??/??/????
		ANGULAR: MACH ± BEND ±		ENG APPR.	
		TWO PLACE DECIMAL ±		MFG APPR.	
		THREE PLACE DECIMAL ±		Q.A.	
		MATERIAL --		COMMENTS:	
NEXT ASSY	USED ON	FINISH --			
APPLICATION		DO NOT SCALE DRAWING			

HDC, Inc.

**A-Bumper Mount
FORD**

SIZE	DWG. NO.	REV.
•		

SCALE:1:10 WEIGHT: SHEET 9 OF 10

REVISIONS				
ZONE	REV.	DESCRIPTION	DATE	APPROVED

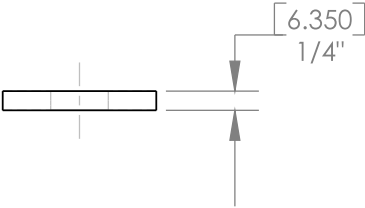
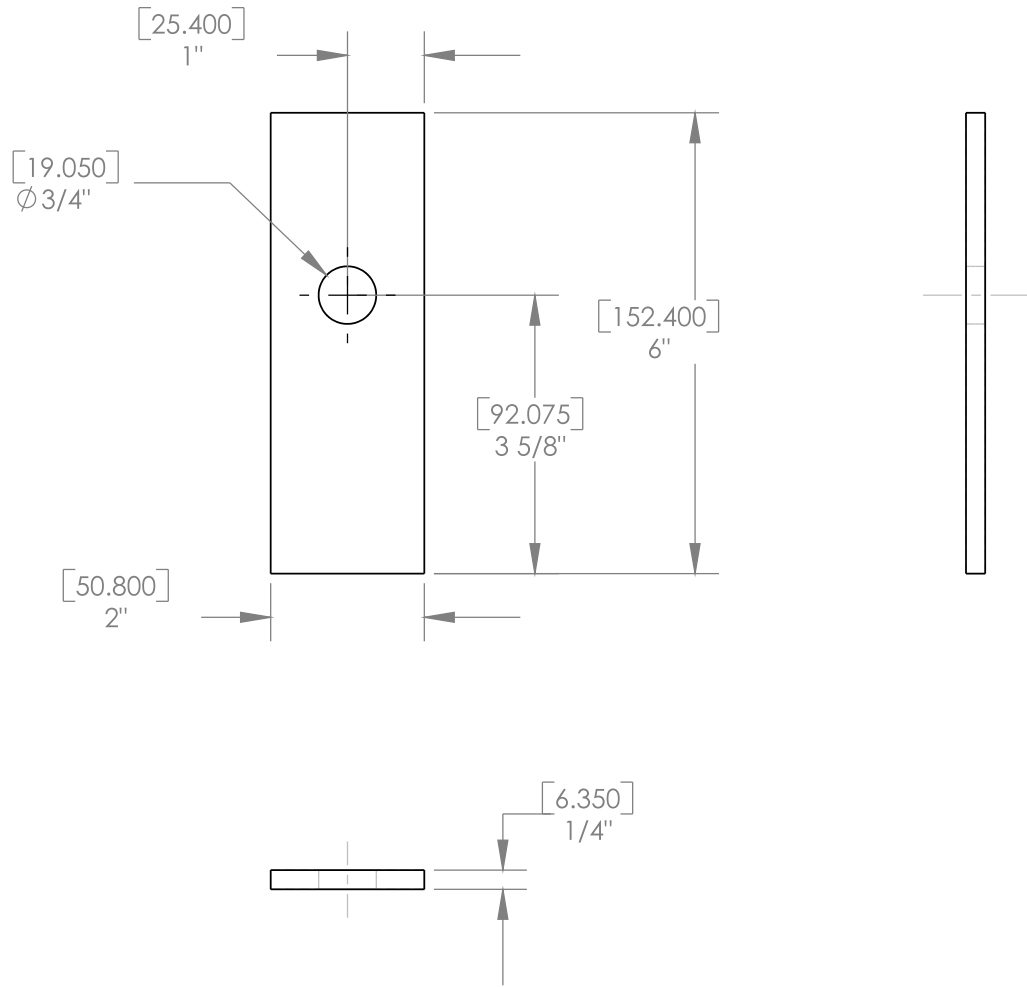

.....
 THE INFORMATION CONTAINED IN THIS DRAWING IS THE SOLE PROPERTY OF HDC, Inc. ANY REPRODUCTION IN PART OR AS A WHOLE WITHOUT THE WRITTEN PERMISSION OF HDC, Inc. IS PROHIBITED.

DIMENSIONS ARE IN INCHES		NAME	DATE
TOLERANCES:		DRAWN	CAK
FRACTIONAL ±		CHECKED	09/11/2006
ANGULAR: MACH ± BEND ±		ENG APPR.	
TWO PLACE DECIMAL ±		MFG APPR.	
THREE PLACE DECIMAL ±		Q.A.	
MATERIAL	COMMENTS:		
1/4" Flat Steel Stock			
FINISH	--		
DO NOT SCALE DRAWING			

HDC, Inc.		
Metal Backing		
SIZE	DWG. NO.	REV.
•		
SCALE: 1:2.5	WEIGHT:	SHEET 10 OF 10